

## Removing and Attaching the Feed Roller

Follow the procedure below to remove and attach the roller unit for cleaning or replacement.



### Note

When attaching the roller unit during installation, operate the roller fastening lever according to the removal procedure and then attach the roller unit.



### CAUTION

Do not use excessive force when removing or attaching the rollers. Doing so may damage them.

## Removing the Roller Unit

1. Pressing the OPEN knob from both sides, raise the upper unit.

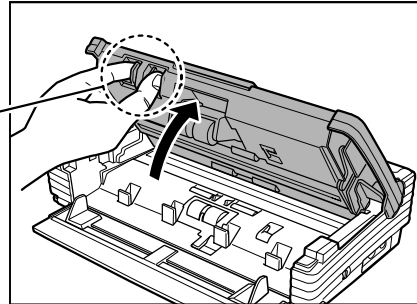
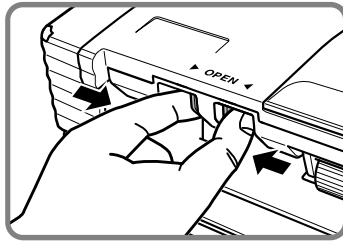

2. Move the roller lock lever towards you.

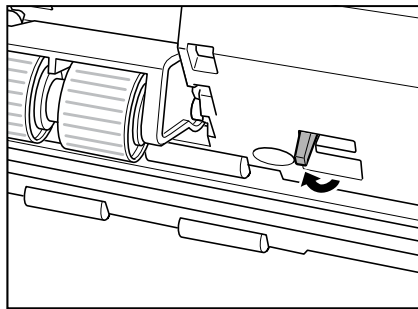

- 
- 3.** Supporting the roller unit with your hand, slide the roller lock lever to the right.

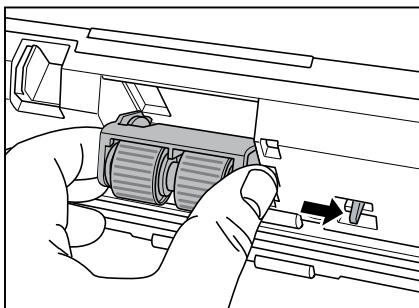

- 4.** Lower the roller unit.

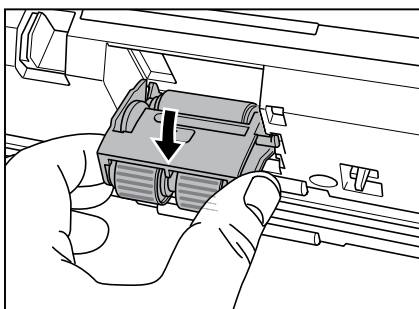

- 5.** First detach the right side of the roller unit (①), and then remove the roller unit (②).

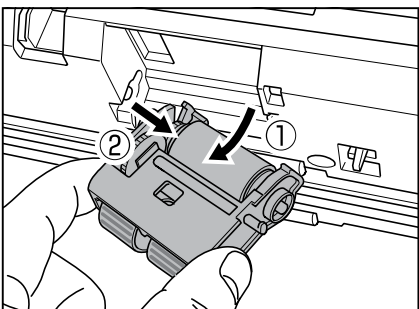

## Attaching the Roller Unit

1. Set the roller unit onto the scanner's shaft.

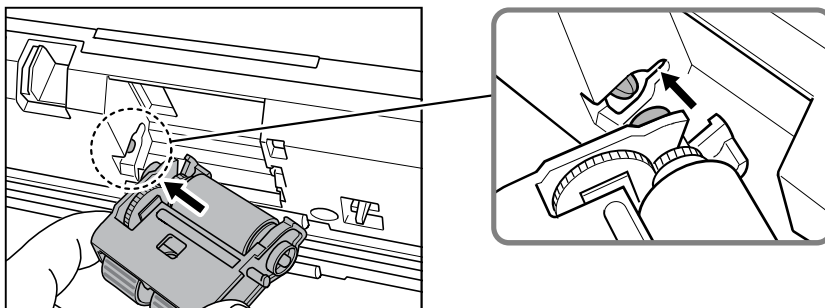

2. Insert the protrusion of the roller unit into the groove in the scanner, and then lift the roller unit.

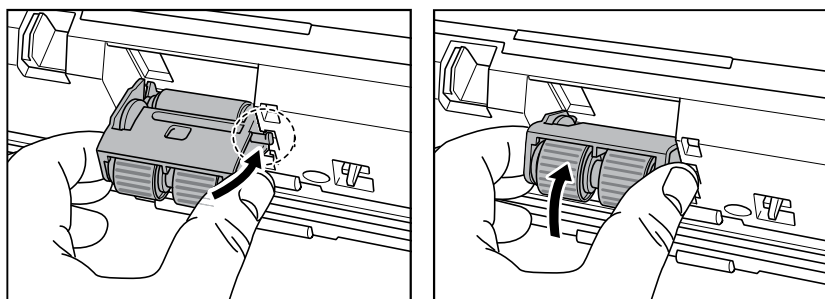

3. Slide the roller lock lever to the left.

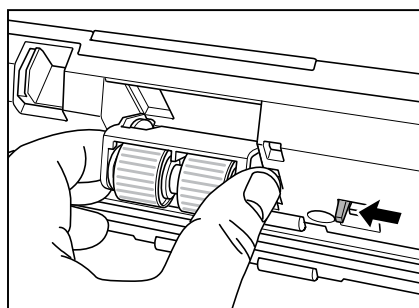

- 
4. Push the roller lock lever towards the back of the scanner to lock the roller unit in place.

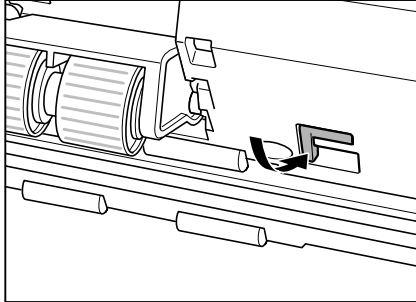

5. Close the upper unit slowly.

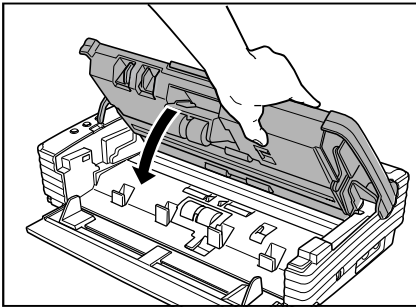

**IMPORTANT**

Do not force the upper unit to close. Doing so may damage the scanner.

6. Be sure that the upper unit is completely closed by pushing on both edges with both hands until you hear a click.

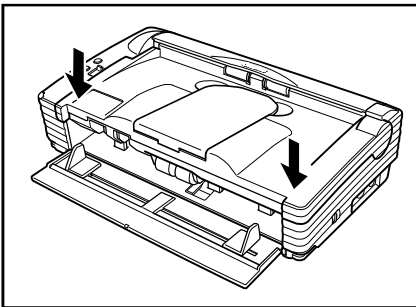

## Removing and Attaching the Retard Roller

Follow the procedure below to remove and attach the retard roller for cleaning or replacement.



### Note

When attaching the retard roller during installation, operate the roller fastening lever according to the removal procedure and then attach the roller unit.



### CAUTION

Do not use excessive force when removing or attaching the rollers. Doing so may damage them.

## Removing the Retard Roller

1. Pressing the OPEN knob from both sides, raise the upper unit.

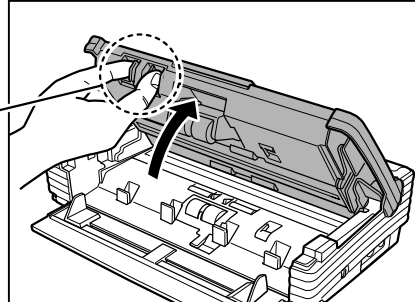
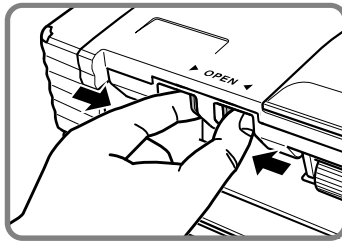

2. Remove the roller cover.

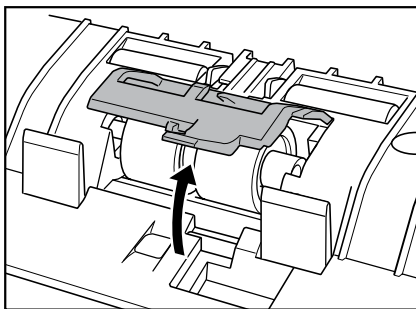

- 
- 3.** Move the roller lock lever upward (①), and then slide it to the right (②).

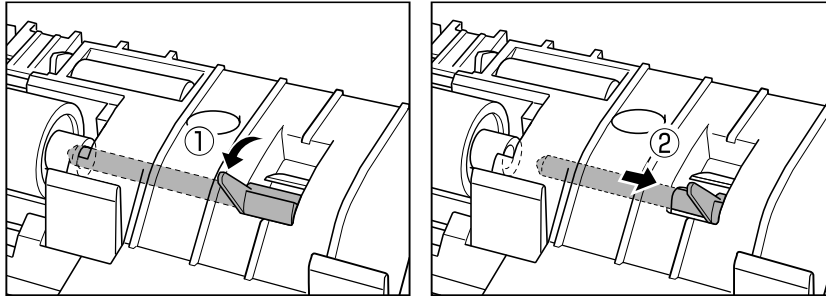

- 4.** Shift the retard roller to the right to remove it.

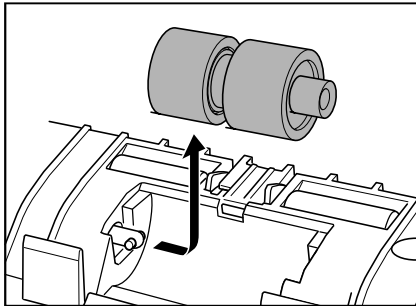

---

## Attaching the Retard Roller

- 1.** Position the retard roller so the notch in the roller is facing the scanner's shaft.

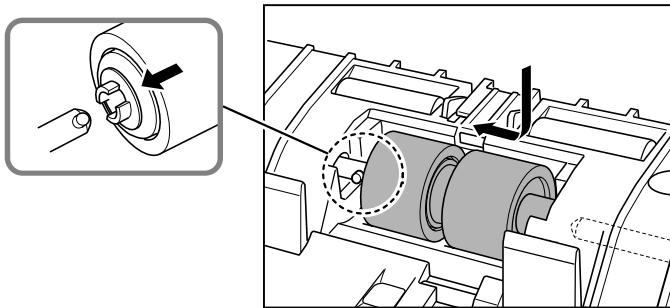

- 2.** Slide the roller lock lever to the left, and insert it into the retard roller hole.

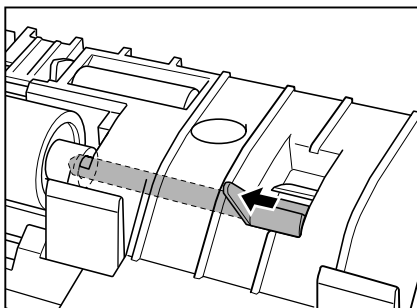

- 3.** Push the roller lock lever towards the back of the scanner to lock the retard roller in place.

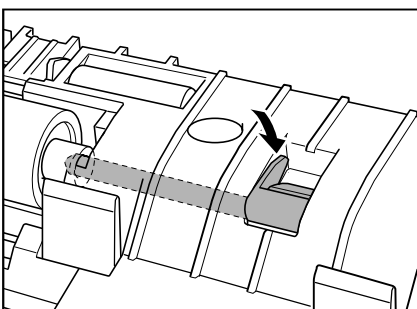

- 4.** Attach the roller cover.

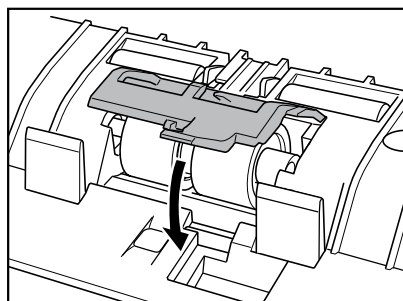
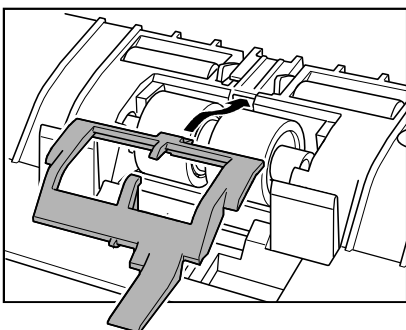

- 5.** Close the upper unit slowly.

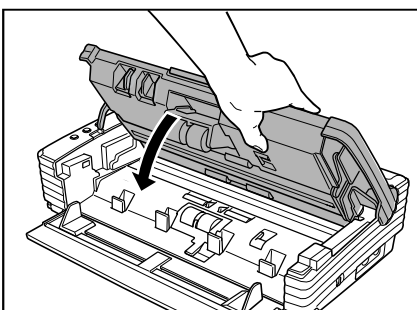

**IMPORTANT**

Do not force the upper unit to close. Doing so may damage the scanner.

6. Be sure that the upper unit is completely closed by pushing on both edges with both hands until you hear a click.

